

Home Plans: Encore Series

Plan 5

Bedrooms / Bathrooms

Dimensions

Floor Space

3 Bedrooms / 1.5 Bathrooms

74' x 16'

1184 Sq. Ft.

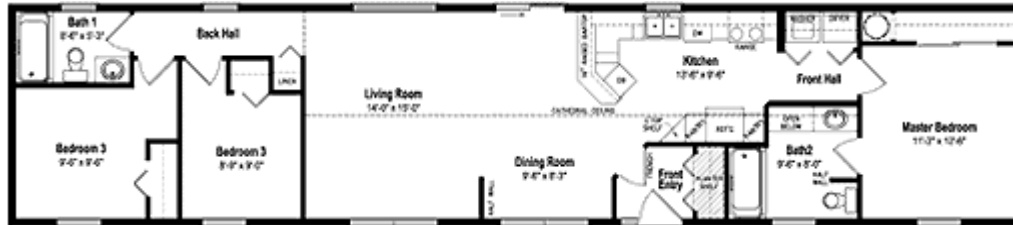

Features Include:

- ✓ All Kiln Dried Lumber
- ✓ 2x6 Walls c/w R20 total Insulation value
- ✓ R32 Roof Insulation
- ✓ R20 Floor Insulation c/w Underboard Standard
- ✓ 4/12 Pitch Roof c/w 25 year Warranty Shingles
- ✓ All Wall Studs & Floor Joists 16" o.c.
- ✓ Vinyl Siding & Trim (color choices available)
- ✓ PVC Single Hung Windows c/w Grills & Tilt Action Sash
- ✓ Shutters on Front Windows (color choices available)
- ✓ 36" Steel Insulated Exterior Doors c/w Vinyl Clad Frame
- ✓ Antique Nickel Deadbolt & Passage Sets on all Exterior Doors
- ✓ Carpet & Vinyl Flooring throughout (color choices available)
- ✓ White Colonial Interior Doors, Bifolds & Trim
- ✓ Designer Oak, Maple or Pine Cabinets (other choices available)
- ✓ Countertops in Kitchen & Baths (color choices available)
- ✓ Double Bowl Stainless Steel Kitchen Sinks
- ✓ Single Lever "Moen" Kitchen Faucet c/w Vegetable Sprayer
- ✓ Recirculating Rangehood c/w Light (White in Color)
- ✓ Appliance Packages available
- ✓ Full Bath c/w Standard White Bath Fixtures & Plate Glass Mirror
- ✓ 5 foot One Piece Dometop Tub & Shower
- ✓ Interior Light Fixture Package
- ✓ Exterior Light at each entrance
- ✓ GFI receptacle standard at Front Entrance
- ✓ Electric Heat; Thermostat controlled each room/area
- ✓ Fully Ducted Ventilation System (Heat Recovery)
- ✓ Smoke Detectors, Door Chime installed
- ✓ One Cable TV Outlet, Telephone Outlet and Data Port
- ✓ Outside Frost Free Tap
- ✓ Shut off valves at Sinks and Toilets
- ✓ 40 Gallon Hot Water Tank
- ✓ 1/2" Gyproc Walls & Ceilings Throughout
- ✓ Wall & Ceiling paint is a primer/sealed only
- ✓ Walls are primer/sealed w/ Cielo Blanco Tint & Ceilings primer/sealed flat white
- ✓ 200 Amp panel box supplied & installed on main floor
- ✓ Wired & Plumbed for Washer/Dryer
- ✓ Delivery of Home to Customers Site
- ✓ Blocked & Tied Down to CMHC Standards
- ✓ 1 Year Manufacturers Warranty
- ✓ 7 Year "Atlantic" New Home Warranty

**Please Note:**

*Due to Prestige Homes' policy of continuous improvement & due to material availability, Prestige Homes reserves the right to alter prices, specifications, plans, details, options and promotions without prior written notice.*

*Please consult T&C Homes for current specifications. T&C Homes can inform you of the estimated completion date for your home. Home completion dates depend on a variety of factors such as weather, road restrictions, project size or complexity and other situations beyond our control.*

*T&C Homes will endeavor to keep you advised of the progress and projected completion date of your home.*

Rev. 09.12.06